

IGATEC - Customized - Swivel Joints

Type SO-T / -CF

Center Flange - Swivel Joints

High Temperature - Swivel Joints

Design According to Customers Requirements



Know How & Consulting directly from manufacturer with decades of experience

That's why you choose... The logo for IGATEC International features the letters 'IGA' in a bold, grey, sans-serif font, followed by the word 'International' in a smaller, grey, sans-serif font. Below 'IGA' and 'International' is a horizontal blue line. To the right of this line, the letters 'TEC' are displayed in a large, bold, grey, sans-serif font.

- **Radial Gaskets**
Allow a maximum of feasible sealing materials and longer lifetime compared to axial gaskets
- **DUPLEX, SUPERDUPLEX, HASTELLOY, ALUMINIUM...**
We machine all compatible materials
- **ASME, NACE, Norsok, DIN...**
We manufacture according to all required Guidelines and Directives
- **Customized Connections**
- **IGATEC – Swivel Joints**
Made of carbon steel (e.g. St52-3, ...) are nitrided to reach maximized hardness of surface and optimized corrosion protection at the same time
- **Certifications**
TA-Luft
VdS
ISO 9001:2008

Division

IGATEC International GmbH
Lange Straße 23-25
D-58089 Hagen

Phone: +49 (0)2331 36 788-0
Fax: +49 (0)2331 36 788-11
eMail: info@igatec-international.de

Headquarter

IGATEC GmbH &
IGATEC International GmbH
Siemensstraße 18
D-67346 Speyer

Phone: +49 (0)6232 91 904-0
Fax: +49 (0)6232 91 904-990
eMail: info@igatec.de

Swivel Joint Type SO-T

Customized - Swivel Joint with Leakage Control

Dimensions:

Nominal diameter	DN15 / 1/2" [larger on request]
Working pressure	10 bar / 145psi *
Working temp.	Up to 250°C / up to 482°F *
Material	1.4571 [other materials on request. E.g. Aluminium, Hastelloy, etc.]
Gasket material	According to customers spec.
Ball material	Depends on ball bearing used
Connection	Threaded (male/female, NPT, BSP, etc.), olive style, customized
Style	11
Application	Universal

* p_{max} and T_{max} may not occur at the same time

Technical Features:

Design	Customized
No. of ball races	2 Ball bearings
Fluid	Compressed air, ...
Type of sealing	Radial
External dust seal	Yes
Secondary seal	Yes
Body	Two parts
Connection for leakage control	Yes
Without grease nipple	Yes
Maximum speed	High, depending on gasket material

Further Advantages:

	Ball bearings and lip seals for higher speed
--	--

Special Design

Completive to the standard range IGATEC is tailoring swivel joints according to customers' requirements.

Technical solutions are drafted and realized in close cooperation with the customer.

3D-CAD-System Inventor enables IGATEC to design 3D-Prototypes of parts, to simulate movements and avoid collisions in front end of production.

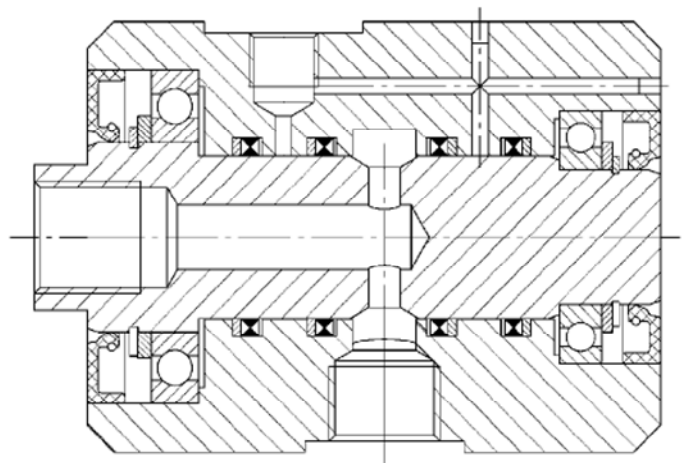
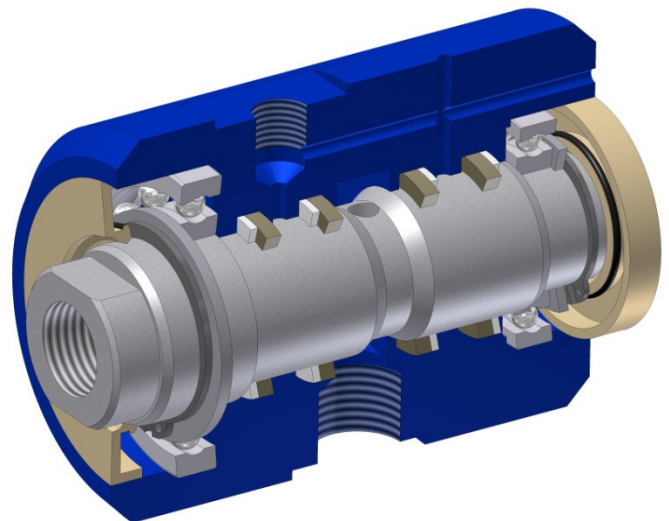

Swivel Joint Type SO-CF

Customized - Swivel Joint with Ball Bearings for High Speed Applications

Dimensions:

Nominal diameter	DN25 / 1" up to DN150 / 6" [larger on request]
Working pressure	10 bar / 145psi *
Working temp.	Up to 110°C / up to 230°F *
Material	1.4571 [other materials on request. E.g. Aluminium, Hastelloy, etc.]
Gasket material	According to customers spec.
Ball material	Depends on ball bearing used
Connection	Flange (ANSI/DIN/special), customized
Style	10, 11, 12, 20, 21,22, 30, 31
Application	Automated food packaging

* p_{max} and T_{max} may not occur at the same time

Technical Features:

Design	Customized
No. of ball races	2 Ball bearings
Fluid	According to customers spec.
Type of sealing	Radial
External dust seal	Yes
Secondary seal	No
Body	Three-parts
Connection for leakage control	Yes
Without grease nipple	On request (e.g. floating suction system)
Maximum speed	High, depends on gasket material

Further Advantages:

	Ball bearings for high speed revolution
--	---

Special Design

Completive to the standard range IGATEC is tailoring swivel joints according to customers' requirements.

Technical solutions are drafted and realized in close cooperation with the customer.

3D-CAD-System Inventor enables IGATEC to design 3D-Prototypes of parts, to simulate movements and avoid collisions in front end of production.

