

FILTRI A DISCHI DISK FILTERS FILTROS DE DISCO



FILTRI A DISCHI DA 1" 1/2

- Filetti G 1 1/2
- Capacità filtrante 14 m³/h
- Corpo in polipropilene rinforzato fibra di vetro
- Dischi in polipropilene
- Guarnizioni in EPDM
- Pressione d'esercizio max. 8 bar

1" 1/2 DISK FILTERS

- 1" 1/2 BSP threads
- Filtering capacity 14 m³/h
- Reinforced fiber glass polypropylene body
- Polypropylene disk
- EPDM gaskets
- Max working pressure 8 bar (116 PSI)

FILTROS DE DISCO 1" 1/2

- Roscas 1 1/2 BSP
- Capacidad filtrante 14 m³/h
- Cuerpo en polipropileno reforzado con fibra de vidrio
- Discos en polipropileno
- Juntas de EPDM
- Presión de ejercicio max. 8 bar



| COD. CODE CÓD. | F (BSP) | Passaggi Opening Pasajes | | Superficie filtrante Filtering area Superficie de filtrado | |
|----------------------|------------|--------------------------------|--------|--|-----------|
| | | Type | micron | cm² | sq.inches |
| F33940125 | G 1 1/2 | Disc | 130 | 281 | 43.5 |

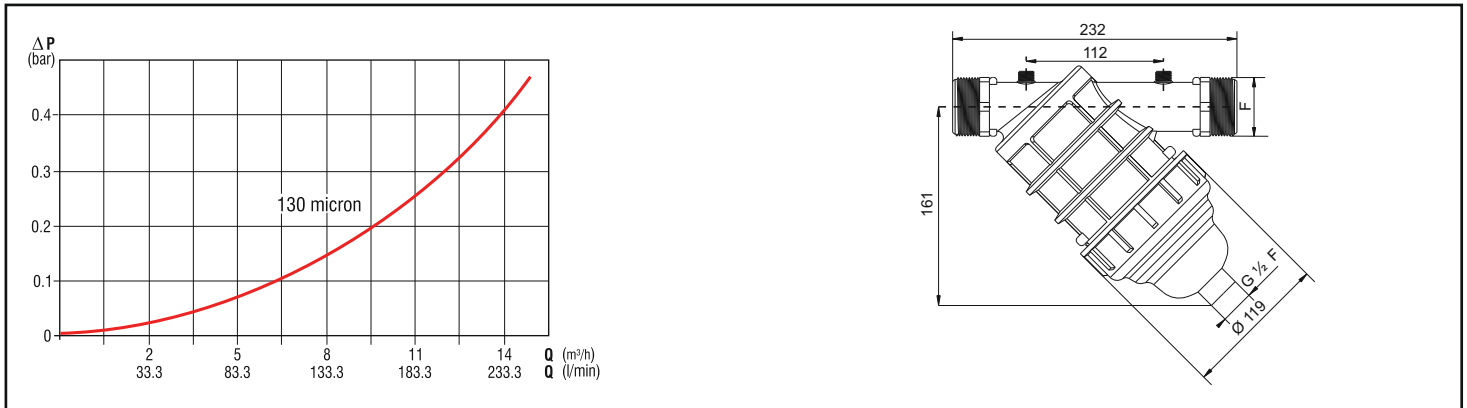

RICAMBI

SPARE PARTS

REPUESTOS

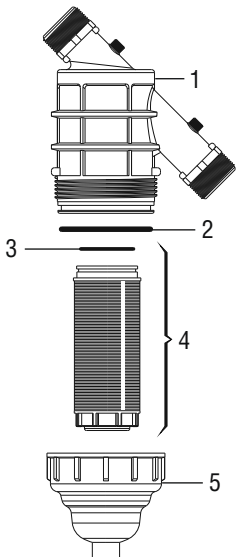

| POS. | COD. / CODE / CÓD. | Micron | Descrizione | Description | Descripción |
|------|--------------------|--------|------------------------|--------------------|----------------------|
| 1 | F323820005 | --- | Corpo filtro | Filter body | Cuerpo del filtro |
| 2 | F316003485 | --- | OR corpo filtro | Filter body OR | OR cuerpo filtro |
| 3 | F316003450 | --- | OR superiore cartuccia | Cartridge upper OR | OR superior cartucho |
| 4 | F34841205 | 130 | Cartuccia filtro | Filter element | Cartucho del filtro |
| 5 | F323950005 | --- | Coperchio filtro | Filter bowl | Tapa del filtro |