

FOR REFERENCE ONLY

SOLENOID VALVE

SPECIFICATIONS for MODEL EXAK-2-N.C

- ORIFICE DIAMETER : 0.8mm
- OPERATING PRESSURE RANGE : IN -40 ~ 100kPa
{-300mmHg ~ 1.0bar}
- OUT 0 ~ 50kPa
{0 ~ 0.5bar}
- FLUID MEDIA : FLUIDS CHEMICALLY COMPATIBLE WITH MATERIALS BELOW
- MEDIA TEMPERATURE RANGE : 0 ~ 60°C
- AMBIENT TEMPERATURE RANGE : 0 ~ 50°C
- RATED VOLTAGE : 12VDC, 24VDC
- POWER CONSUMPTION : 0.94W
- DUTY CYCLE : CONTINUOUS
- INSULATION CLASS : CLASS B
- DIELECTRIC STRENGTH : 1500VAC FOR 60s

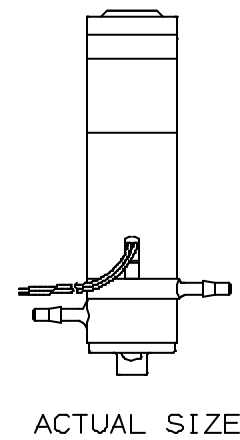
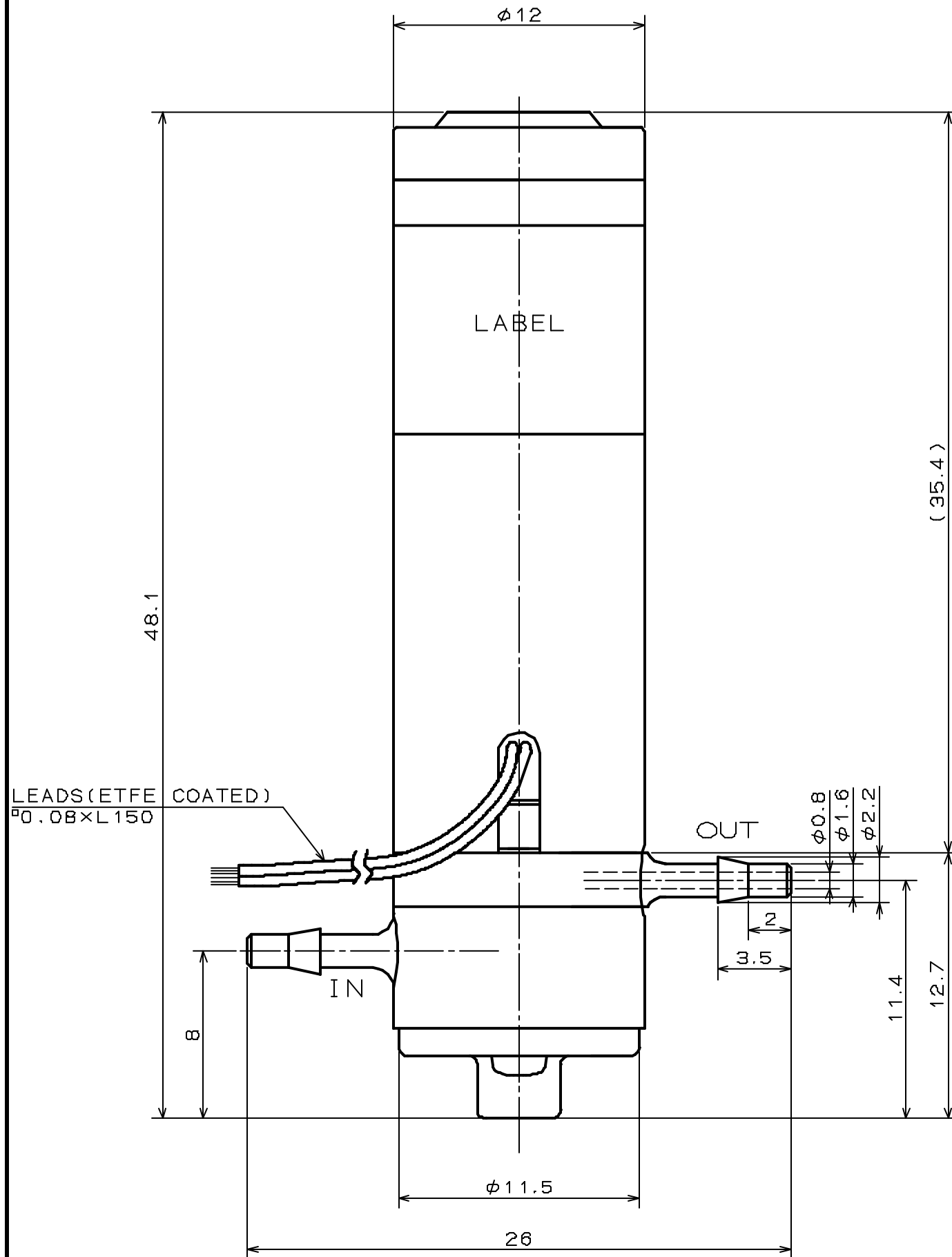

WETTED MATERIALS

RETAINER	PTFE	1	
VALVE BODY A	PFA	1	
DIAPHRAGM	PTFE	2	
VALVE BODY D	PFA	1	
PART NAME	MATERIAL	REQD.	NOTE
SOLENOID VALVE			
EXAK-2-N.C			