

s.100 / s.101

3-way hot forged 1/4"-2" brass ball valves



Features and Specifications:

- 3-way T (s.100) or L (s.101) design allows complete range of flow handling applications
- Hot forged sand blasted nickel plated brass body and caps
- Copper alloy brass according to EN 12165 and EN 12164 specifications
- Approved by GOST-R (RU), Hygenic (RU), ROSTEKHNADZOR (RU), UkrSevro (U)
- Extra port for lowest pressure drop
- PTFE seats
- UNI 8858 cycle and torque tests performed
- Four seats design limits mixture among various fluids in the system
- Chrome plated brass ball for longer life
- No metal-to-metal moving parts
- Two NBR O-rings at the stem for maximum safety
- ISO 228 Female threads
- See non-shock cold working pressure on chart
- Range: -10°C +120°C temperature (Warning: freezing of the fluid in the installation may severely damage the valve)



The product described in this document meets the requirements of PED Directive 97/23 and according to art.3 par.3, it does not require CE marking; it cannot be used with dangerous gases in sizes larger than 25mm; it cannot be used with non-dangerous gases in sizes larger than 40mm.

Approved By:



NOTE: Approvals apply to specific configurations only.

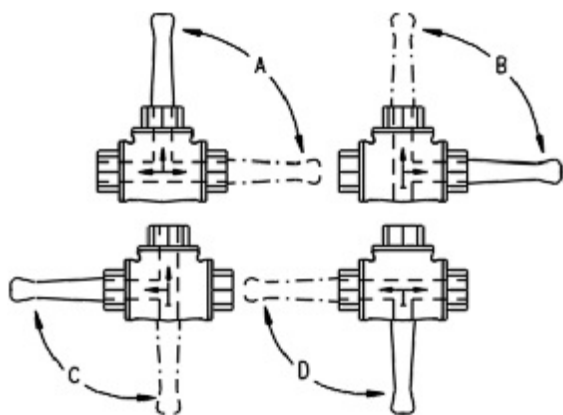

s.100 3-way T port

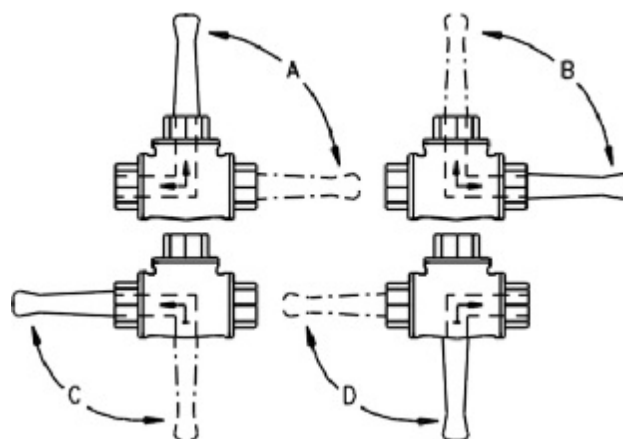

s.101 3-way L port

s.100 / s.101

3-way hot forged 1/4"-2" brass ball valves



Technical Specifications:

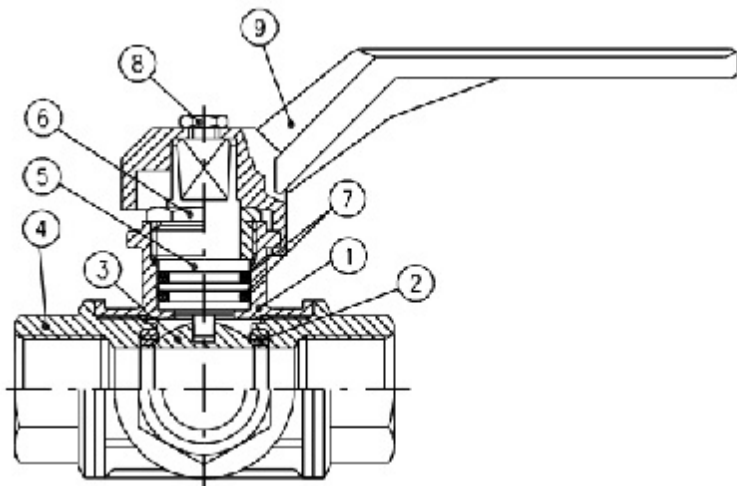

| PART DESCRIPTION | | Q.ty | Material |
|------------------|----------------------------------|------|-----------|
| 1 | Nickel plated body | 1 | CW617N |
| 2 | Seat | 4 | Ptfe |
| 3 | Chrome plated ball | 1 | CW617N |
| 4 | Nickel plated end cap | 3 | CW617N |
| 5 | Nickel plated stem O-ring design | 1 | CW614N |
| 6 | Nickel plated nut | 1 | CW614N |
| 7 | O-ring | 2 | NBR |
| 8 | Screw | 1 | Steel |
| 9 | Red handle | 1 | Aluminium |

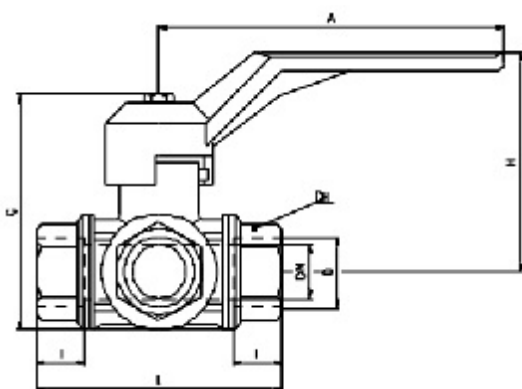

| Code | 100B00 | 100C00 | 100D00 | 100E00 | 100F00 | 100G00 | 100H00 | 100I00 |
|----------|--------|--------|--------|--------|--------|--------|--------|--------|
| | 101B00 | 101C00 | 101D00 | 101E00 | 101F00 | 101G00 | 101H00 | 101I00 |
| D (inch) | 1/4 | 3/8 | 1/2 | 3/4 | 1 | 1 1/4 | 1 1/2 | 2 |
| DN (mm) | 10 | 12 | 14 | 18 | 23 | 29 | 36 | 45 |
| I (mm) | 19 | 19 | 19 | 23 | 25 | 27 | 31 | 36 |
| L (mm) | 77 | 77 | 77 | 92 | 104 | 118 | 138 | 162 |
| G (mm) | 75 | 75 | 75 | 91 | 105 | 115 | 128 | 165 |
| A (mm) | 125 | 125 | 125 | 145 | 170 | 170 | 170 | 260 |
| H (mm) | 65 | 65 | 65 | 83 | 96 | 102 | 109 | 139 |
| CH (mm) | 22 | 22 | 27 | 34 | 41 | 50 | 57 | 70 |

Ask for additional information on the whole range of **RuB** valves and consult with your supplier for special applications.

Pressure - Temperature Chart

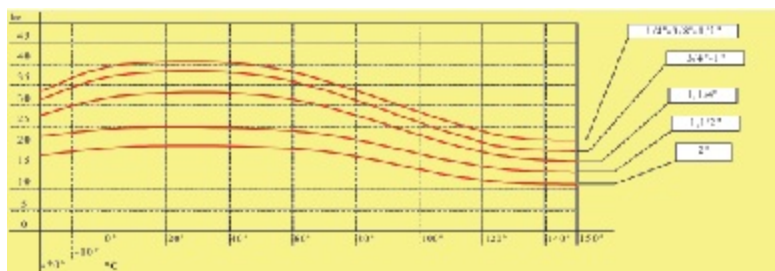

Pressure Drop Chart

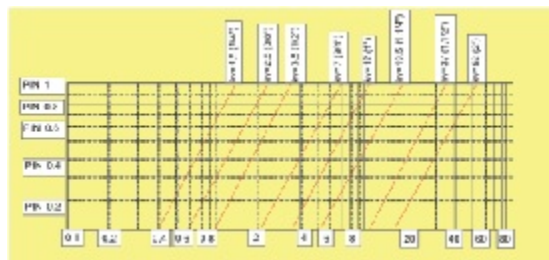

The company reserves all rights for the information contained herein. Products may be changed at any time without notice. Any undated reference to a code or standard shall be interpreted as referring to the latest edition. RuB and logo are registered trademark of RuB-Rubinetteria utensilerie Bonomi. Others logos are property of respective owners.

RUB RUBINETTERIE UTENSILERIE BONOMI

Via Padana Superiore 27/29 25080 Ciliverghe di Mazzano (Bs) Italy
Ph: +39 030 212441 - Fax: +39 030 2629498
sales@rubvalves.com - www.rubvalves.com

